

# OPTIONAL ACCESSORIES

The adapted propeller for each use :

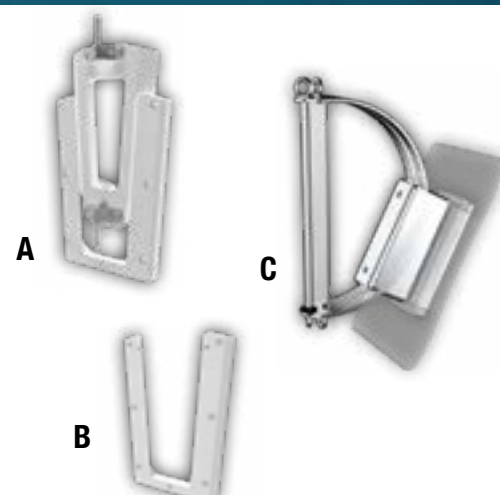

The adapted mounting kit for each transom :

**A. Removable mounting kit for transom :**

It includes 1 U-support (fixed to the hull) and 1 V-support (fixed to the hydrogenerator). It allows an easy and removable installation of your hydrogenerator, and suits many types of transoms. This revised item also includes an easy locking system ! **Ref FA-04**

**B. Extra U support for removable mounting kit ref FA-03 :**

It allows a removable mounting on both sides (port – starboard). With this kind of mounting, the short hydrogenerator is more adapted. **Ref U-03**

**C. Deluxe universal support for all transoms :**

It allows a removable mounting system correcting the hull angle. Deluxe finish in polished stainless steel. **Ref FU-03**

Extra accessories :

**D. IP67 waterproof connection kit :**

Ideal for removable installations, supplied with 10 meters of cable. Its high quality guarantees an optimum electrical connection. **Ref PL-04**

**E. Lifting and immersion 4:1 hoist :**

Facilitates the immersion/release of the hydrogenerator by dividing the forces. **Ref PA-04**

**F. ON/OFF relay :**

It allows to cut the power supply between the converter and the hydrogenerator when batteries are loaded (POD600 use or when the hydrogenerator cannot be lifted up). The hydrogenerator would thus turn slowly, in silence. **Ref A-000000-00436 (12V) / A-000000-00437 (24V)**

**F. Hydrogenerator bags :**

Bag to carry, protect and store the hydrogenerator. Essential !  
For 610 mm leg : **Ref BAG-610-01** For 970 mm leg : **Ref BAG-970-01**



## CRUISING HYDROGENERATORS



Designed in 2008 and continually improved since, the watt&sea hydrogenerators have radically changed energy management on board. They allow nothing less than the total autonomy of sailing boats !

Validated on all seas around the globe, they are the most powerful, reliable and the lightest available on the market.

### BENEFITS

- + 120W production (10A in 12Vcc) at 5 knots
- + Wide range adapted to many sailboats and speeds
- + Ultra light thanks to brushless alternator technology : mounting and dismantling are simplified
- + Propeller behind the leg, protected from floating objects
- + Very silent for everybody's comfort
- + Hydrodynamic design : unperceivable drag, not affecting boat speed
- + 2-year warranty

Used by the best sailors, in the most extreme seas of the globe, watt&sea hydrogenerators are recognized around the world as the most advanced and efficient !

## AFTER-SALES SERVICE



**Servicing for hydrogenerator :**

watt&sea recommends servicing every two years or every 10,000 miles to check the system, bearings and replace oil. Please contact your reseller to check available packages, or consult [www.wattandsea.com](http://www.wattandsea.com).



# CRUISING 300

An energy output up to 300 W (24 A in 12 V) for greater comfort when sailing. Designed for boats under 35 feet that usually sail between 4 and 6 knots, with an average consumption of 8 A in 12 V. Delivered with a 240 mm propeller (8 A at 5.2 knots), the CRUISING 300 can produce even more with the 280 mm prop (8A at 4.5 knots)

Available in 3 versions :  
short leg (Ref PK-610-300) / long leg (Ref PK-970-300)  
or customized for Mini 6.50 (Ref PK-MINI-300)

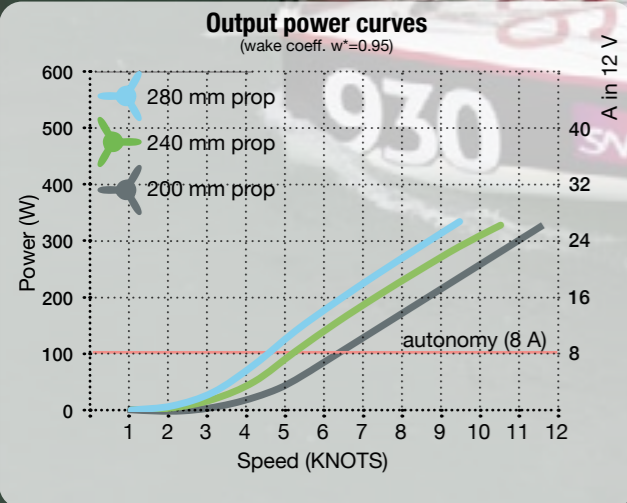

# CRUISING 600 & POD 600

Power generation up to 600 W, ideal for 35+ feet sailing boats with an average consumption around 10 A in 12 V. For full energy independence when cruising, racing or during long crossings. The output rises exponentially above 6 knots. Delivered with a 240 mm propeller (10 A at 5.6 knots), the CRUISING 600 model can be fitted with a range of 4 propellers for all speeds from 3 to 20 knots !

Available in 3 versions :  
short leg (Ref PK-610-600) / long leg (Ref PK-970-600)  
or POD version (Ref PK-POD-600)

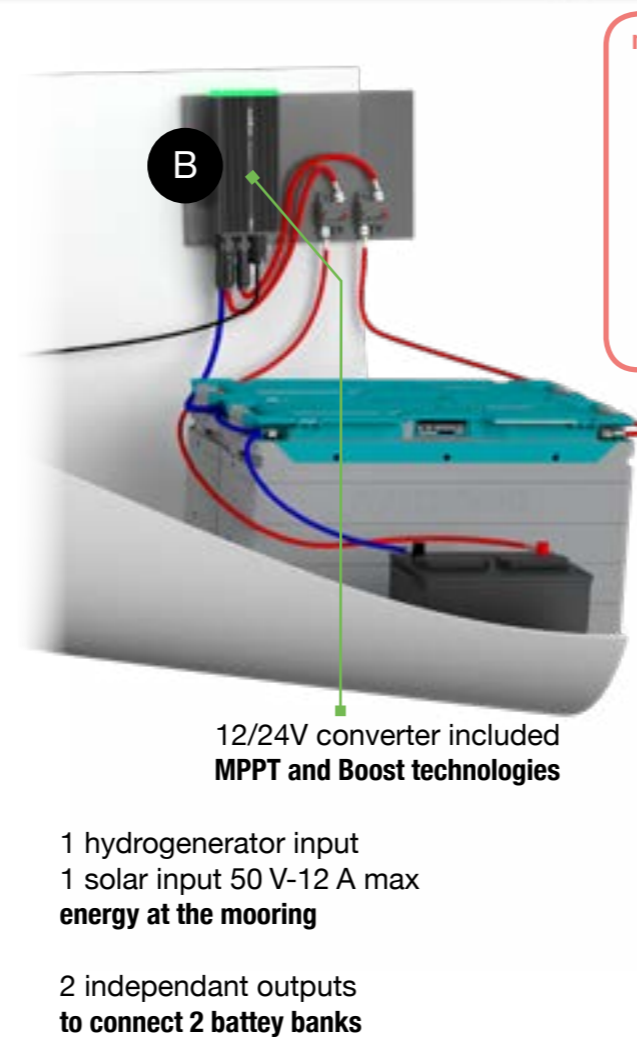
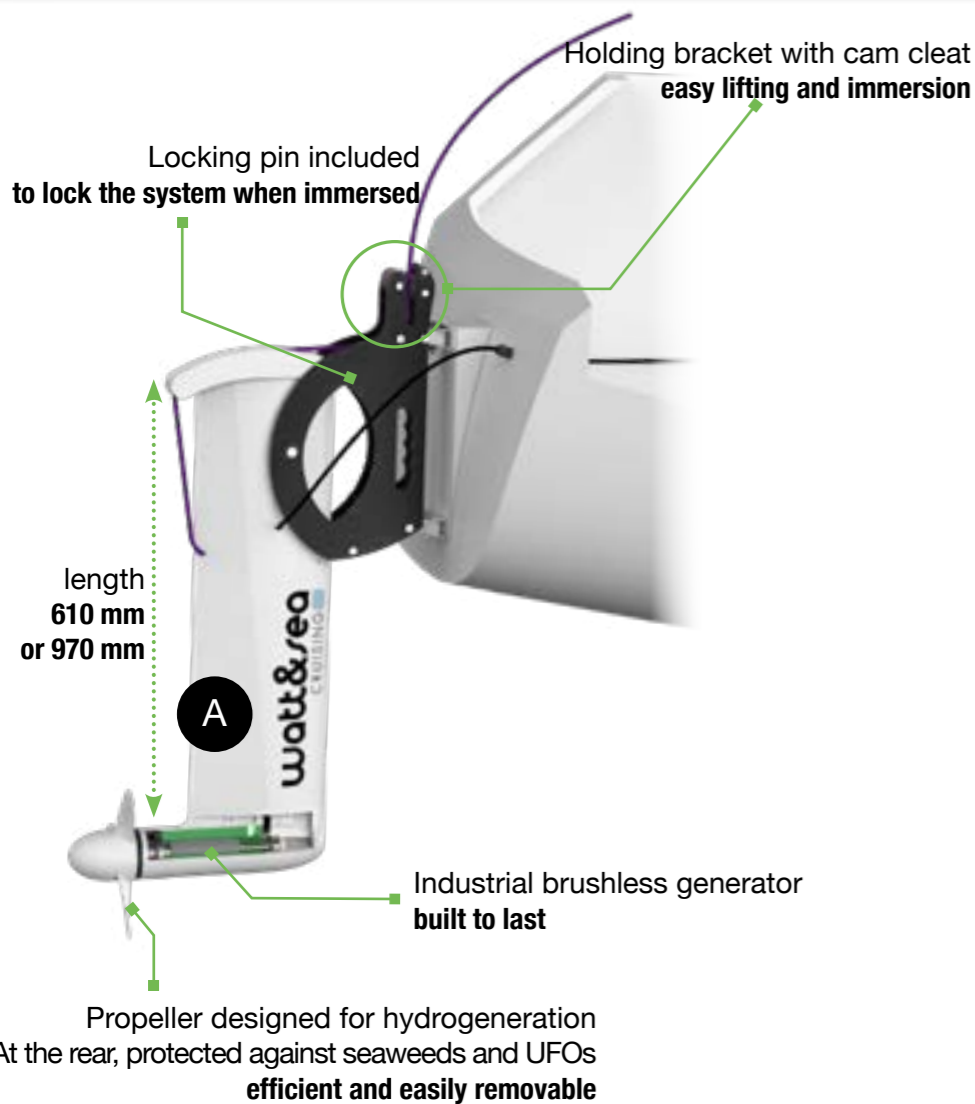
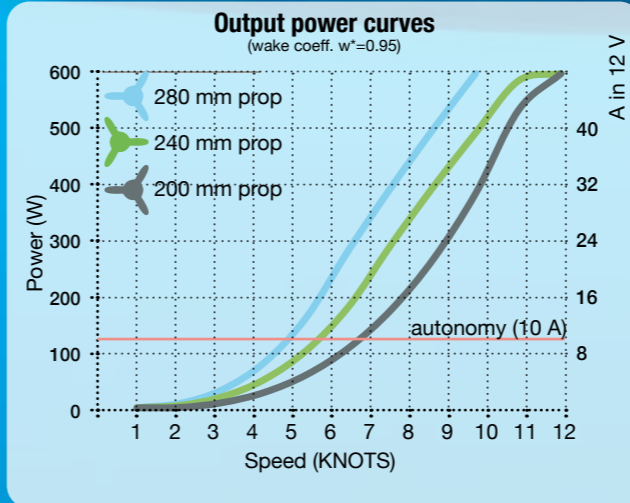

**new 2020**

Mobile App to see the production at a glance

GET IT ON Google Play

Download on the App Store

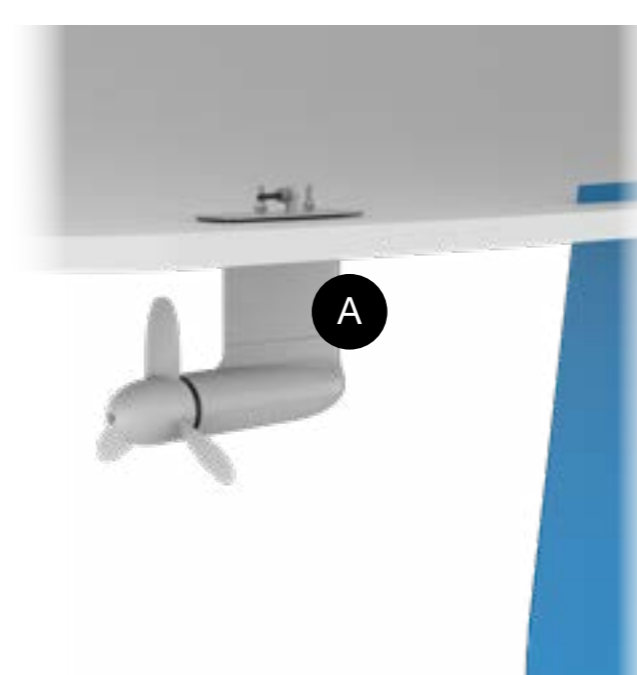

## PACK CHARACTERISTICS

Charging voltage	12 or 24 V autodetected
Maximum using speed	20 knots with the adapted propeller
Leg length	610 mm    970 mm
Overall length with bracket	920 mm    1280 mm
3-phase wire length	4 m (13 ft)
Compatible batteries	All incl. Lithium
Pack contents	1 hydrogenerator (A) 1 converter (B) 1 240 mm propeller (C) For transom fit packs : 1 low friction ring 2 settings forks for transom 2 premounted wires 1 bag of connectors
Hydrogenerator weight	6.3 kg    610 mm/300 W 7.1 kg    970 mm/300 W 7.4 kg    610 mm/600 W 8.2 kg    970 mm/600 W 4.5 kg    POD 600 W
Converter weight	1.5 kg
Warranty	2 years

\*: not for model POD 600